

Contact Rating	0.4Volt-Amps(VA) max @20V (AC of DC)
Electrical Life	50,000 make-and-break cycles at full load
Contact Resistance	20mΩ max. initial @ 2-4VDC, 100mA for both silver & gold plated contacts
Insulation Resistance	1000 MΩ min
Dielectric Strength	1500 V RMS @ sea level
Operating Temp	-30°C to 85°C

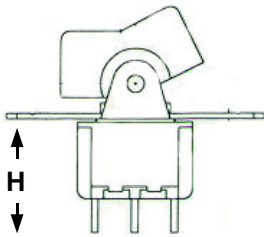
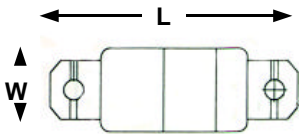

Model No	Action	W x L x H (mm)	Function
WSP-1	SP DT	8 x 28 x 13	On None On
WSP-2			On None (On)
WSP-3			On Off On
WSP-4			(On) Off (On)
WSP-5			On Off (On)
WDP-1	DP DT	9 x 28 x 13	On None On
WDP-2			On None (On)
WDP-3			On Off On
WDP-4			(On) Off (On)
WDP-5			On Off (On)

Actuator

R1 Standard Rocker

Termination

- M1 Solder Lug
- M2 PC Mounting
- M6 Right Angle
- M7 Vertical

Contact Material

- Q Silver
- G Gold
- R Gold (0.4VA max 20V)

NB Termination: Straight PC Mounting with Support Bracket available, please request further information

How To Order

